

BCS-03

Assembly Instructions



Important info and symbols.

You will need a sharp, narrow blade such as a utility or a hobby knife and some wood glue.

Some parts of the assembly has to be able to move. Be careful to not get glue into those areas, and allow glue to dry on parts before sliding them into place.

Parts are named sheet first, part second. Ex. 2.5 means sheet two, part 5. Parts that are the same, have the same number.

NB!!! Please do not print out these instructions unless absolutely necessary.

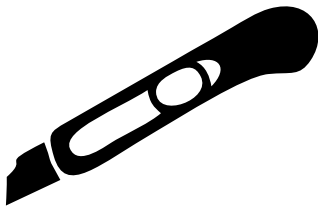

Cutting required



Glue required



Do not glue

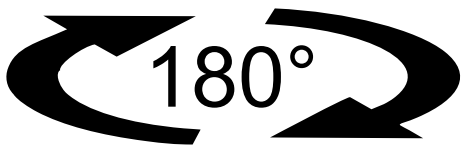

Turn horizontally

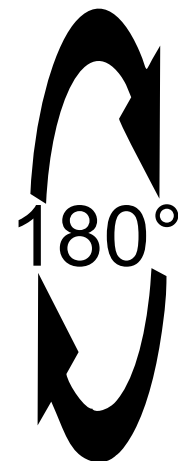

Turn vertically



Warning: Choking hazard. Kit contains small parts.
Not suitable for children under 3 years old.

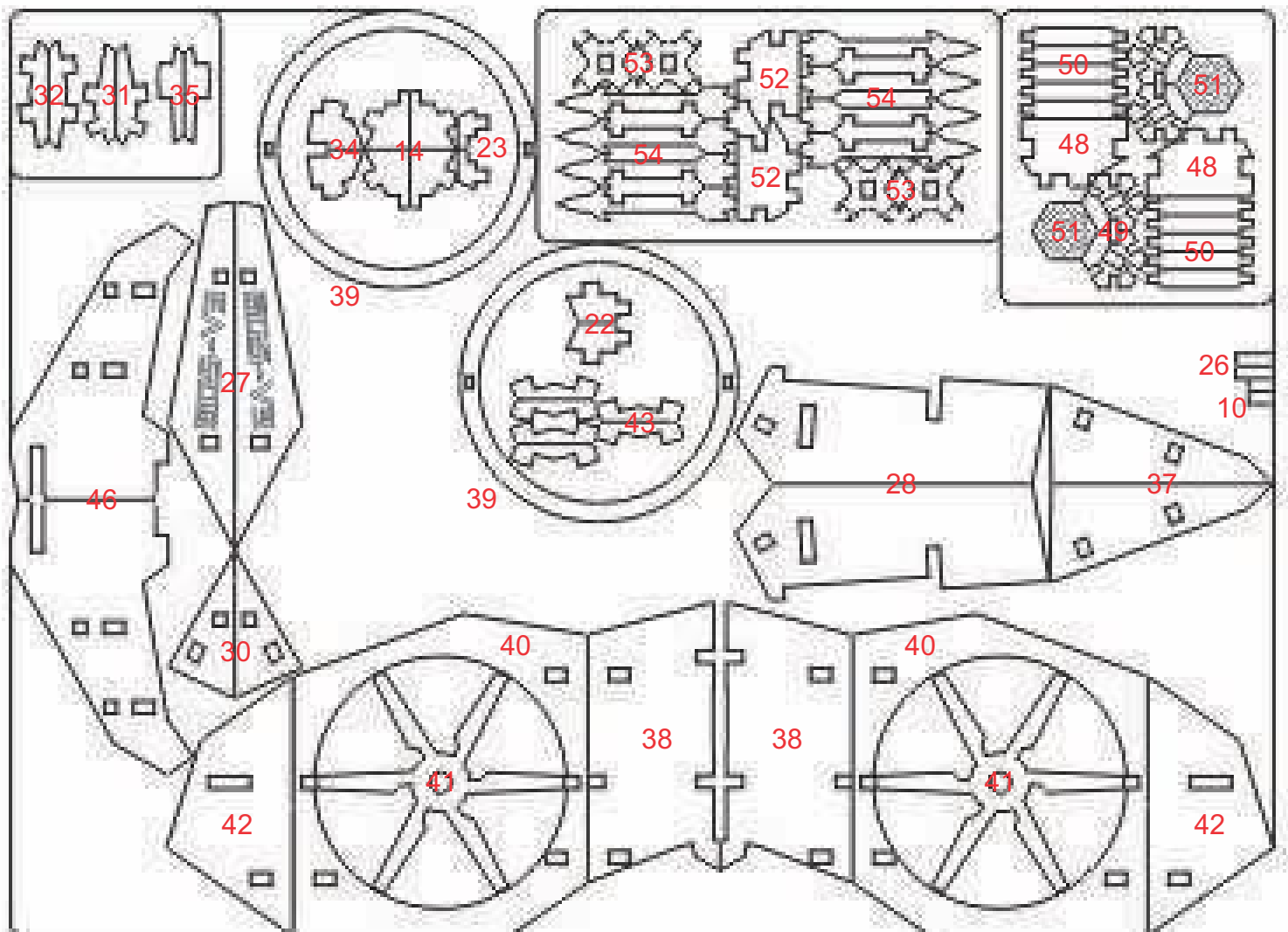
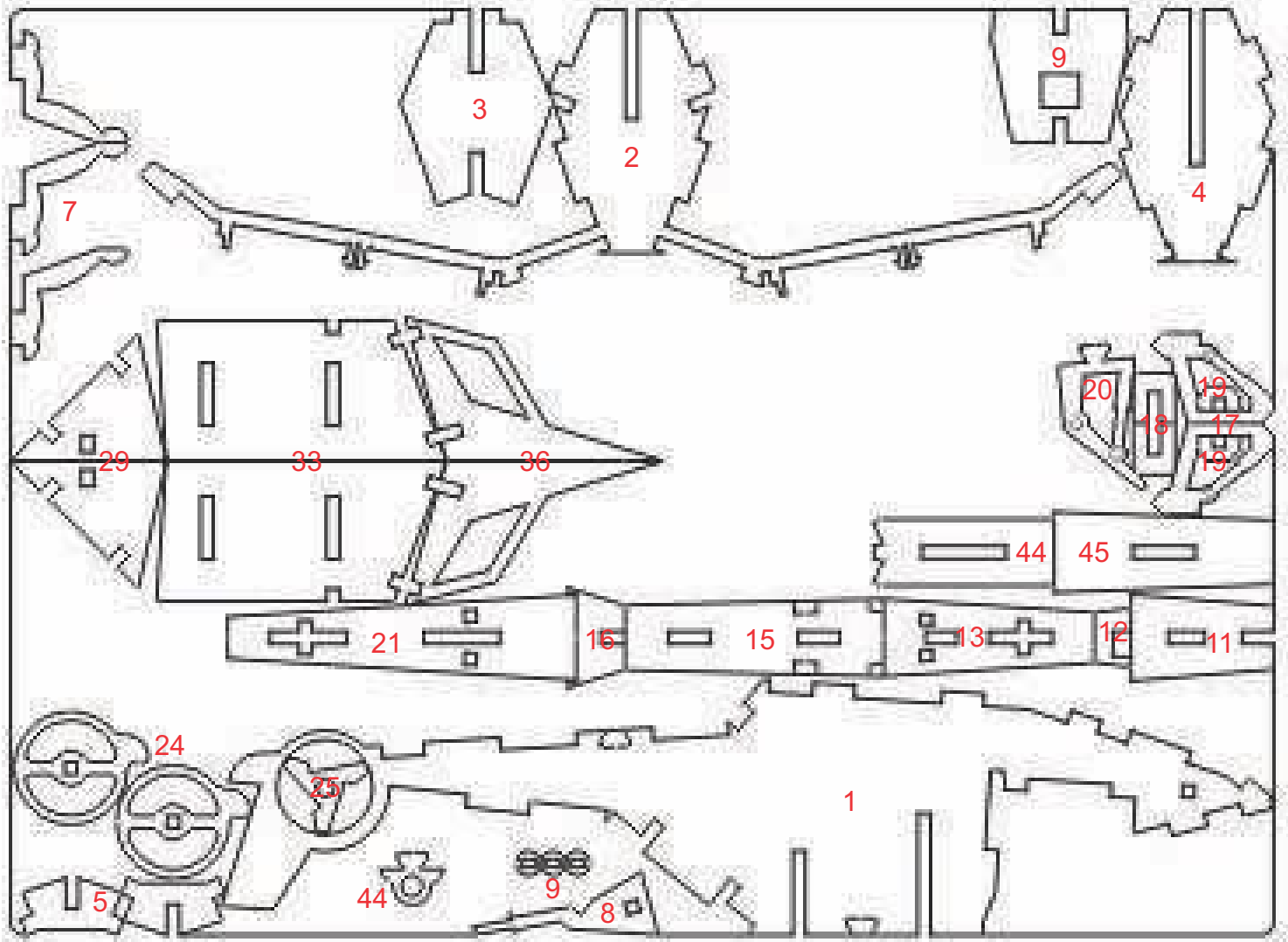

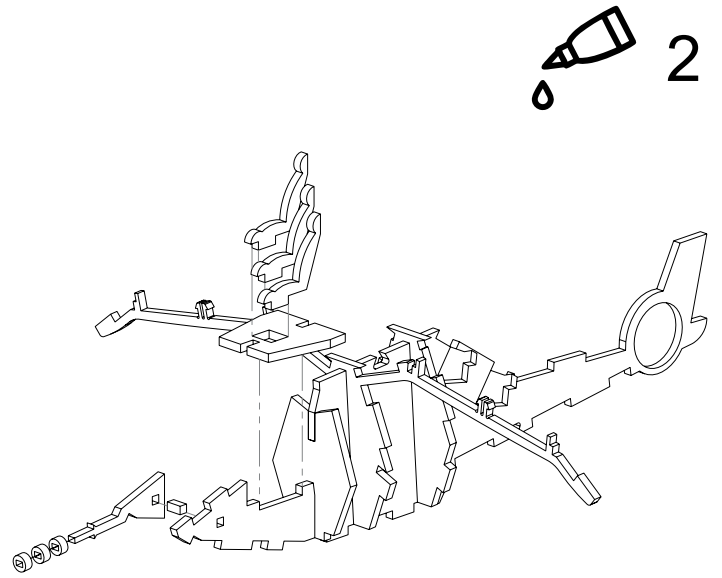
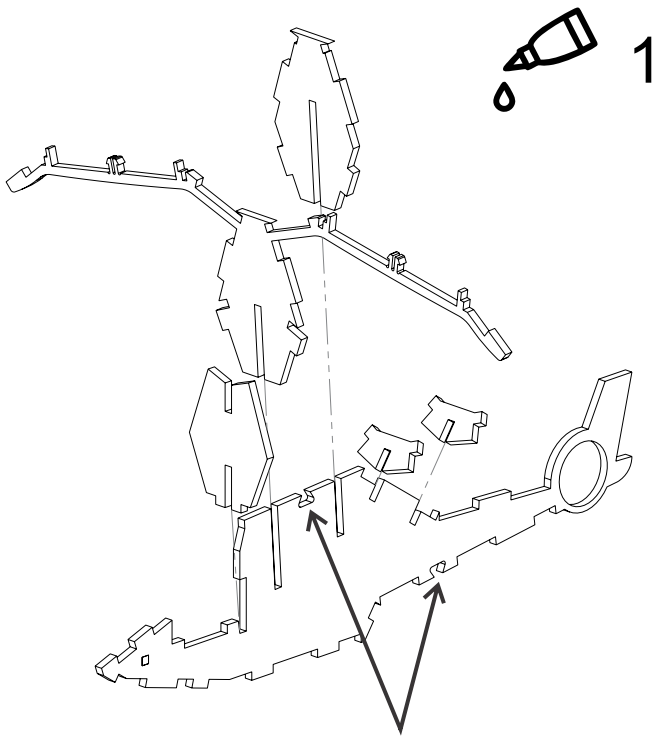
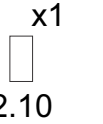
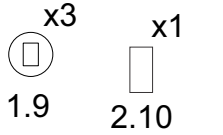
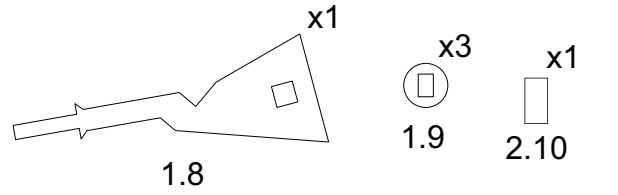
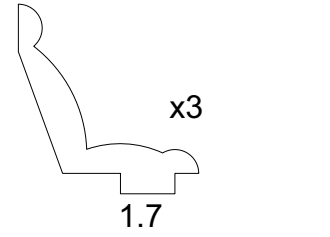
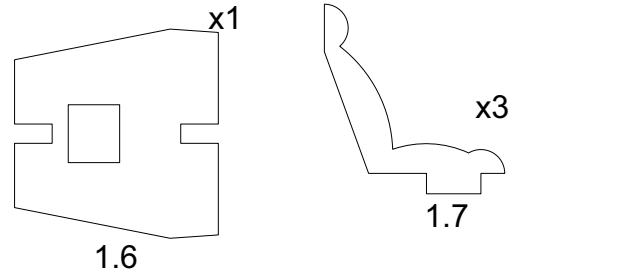
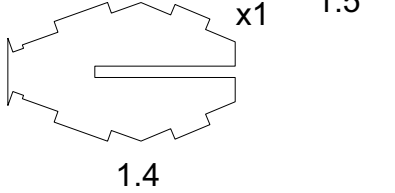
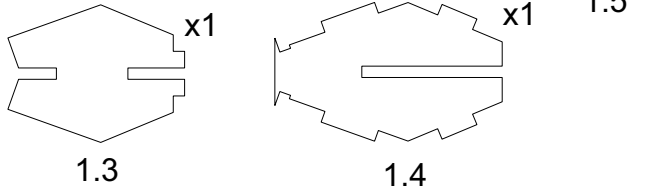
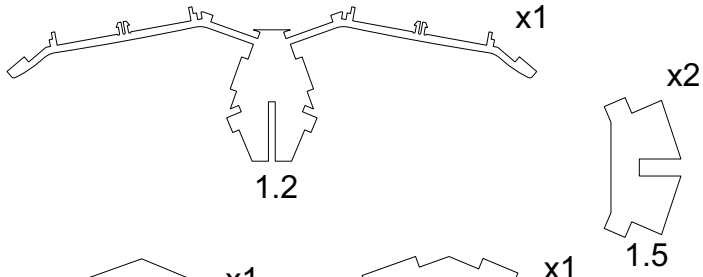
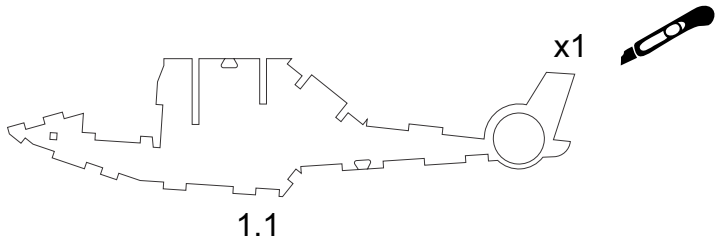

Cut out these parts if you intend to hang the BGS-v3 or to stand it on its landing gear.

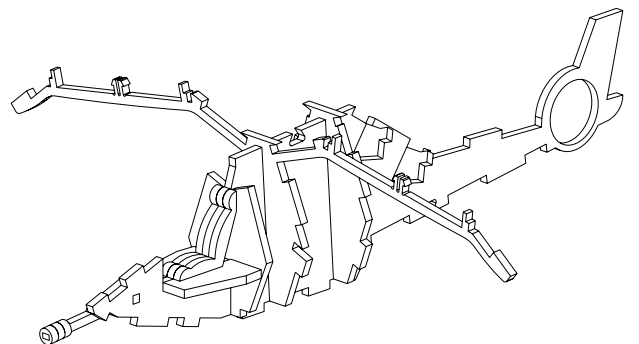
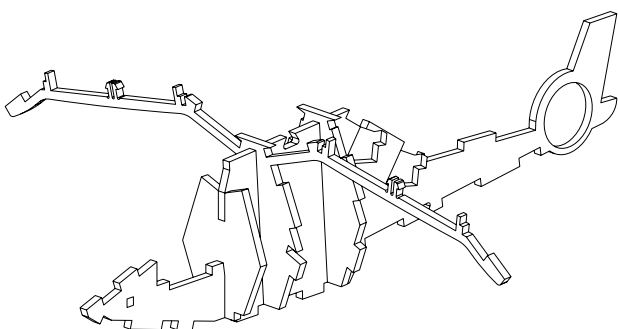

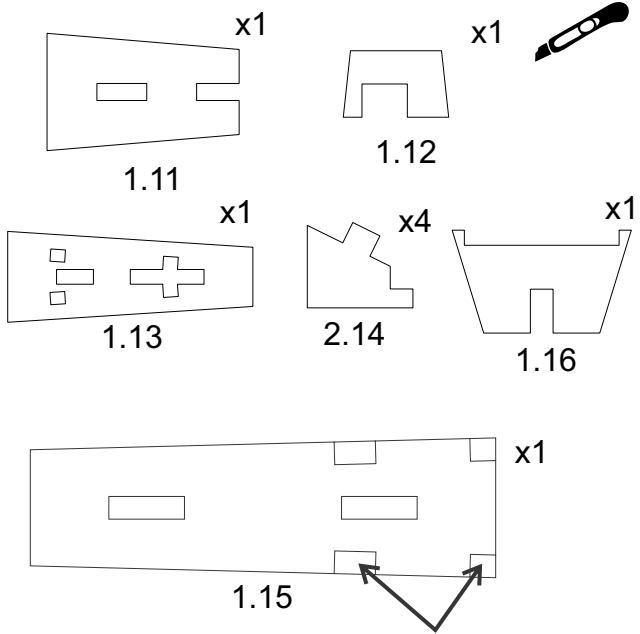

If you don't want the BGS-v3 to stand on its landing gear, you can skip the following two steps.

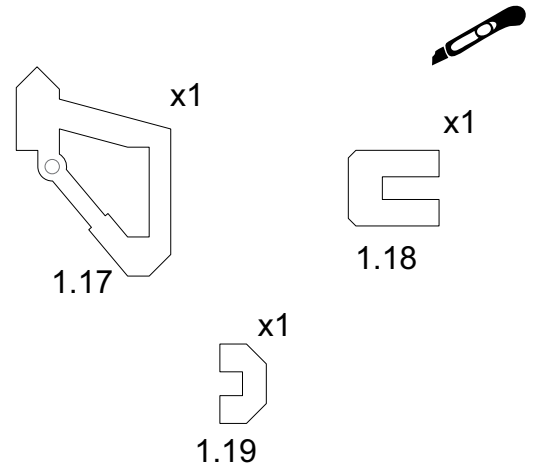

Cut out these parts if you intend to have the BGS-v3 stand it on its landing gear.

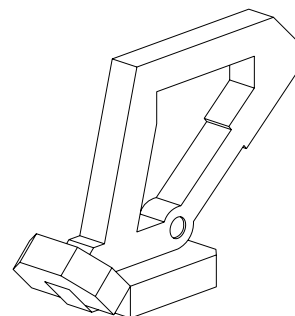
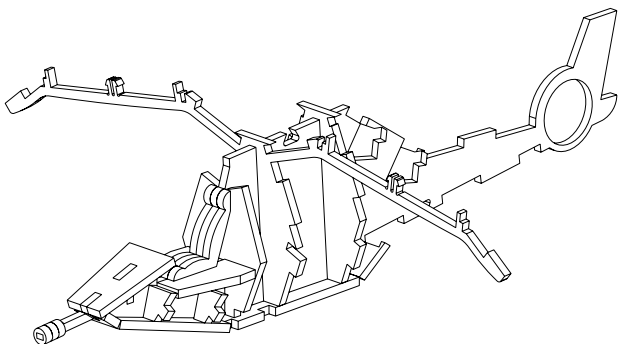
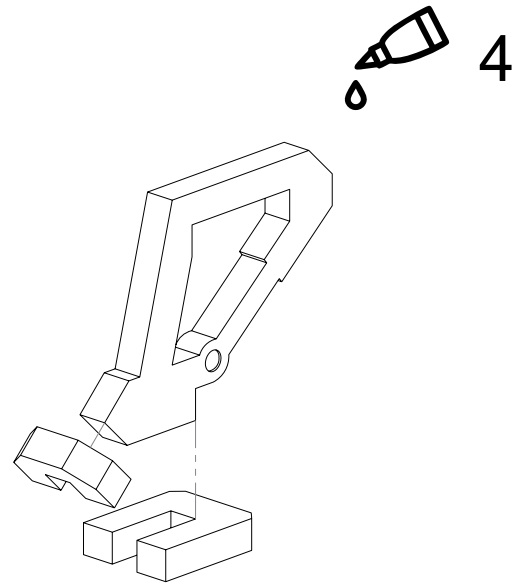
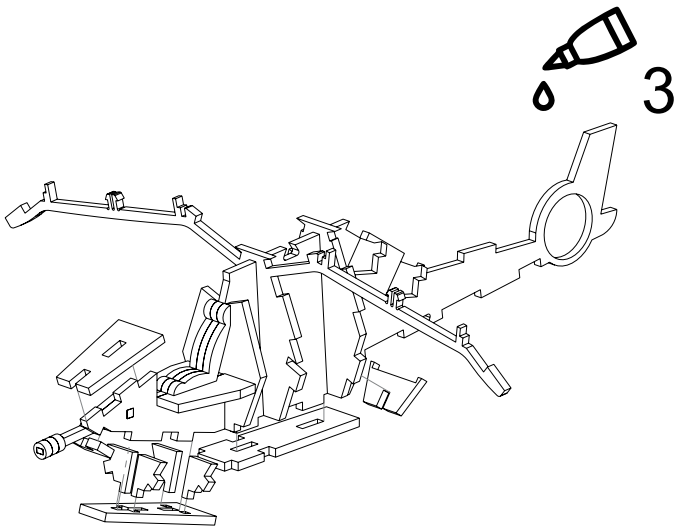

x2

If you don't want the BGS-v3 to stand on its landing gear, you can skip this part.

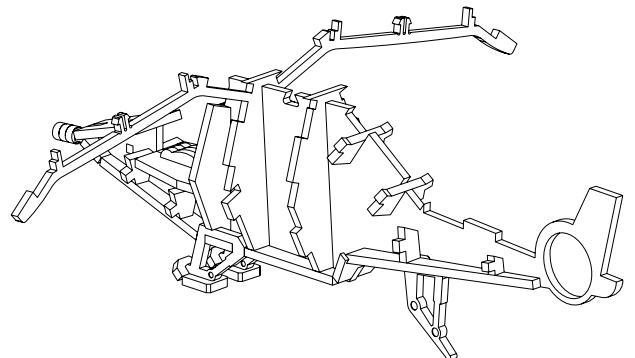
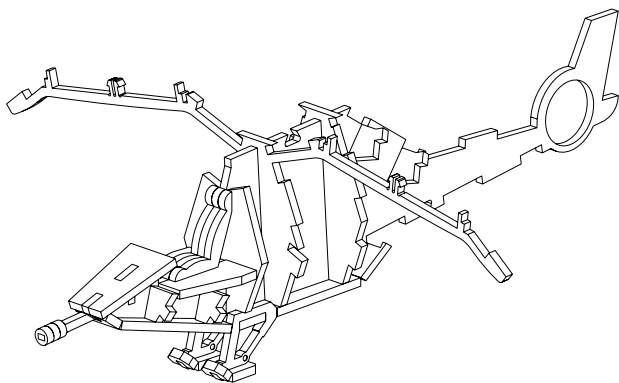
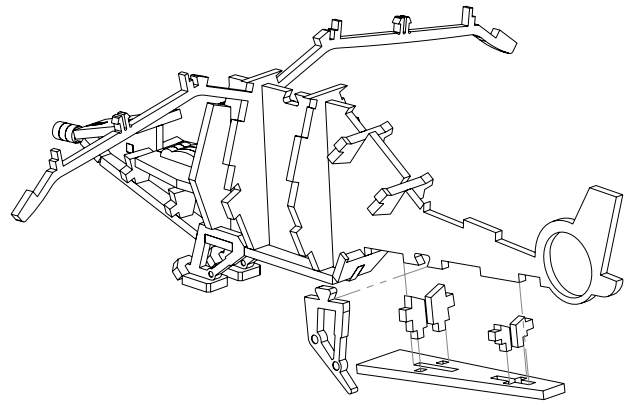
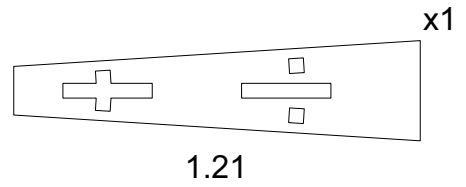
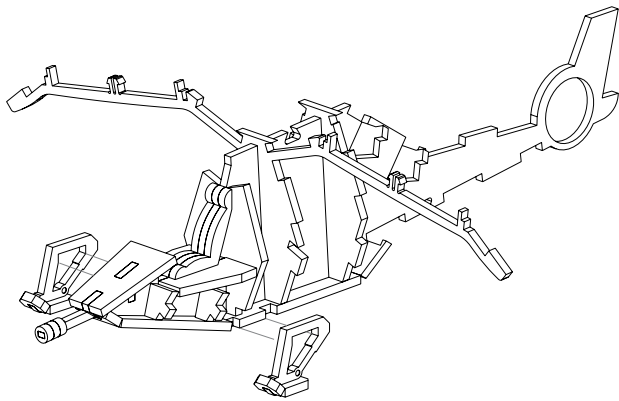
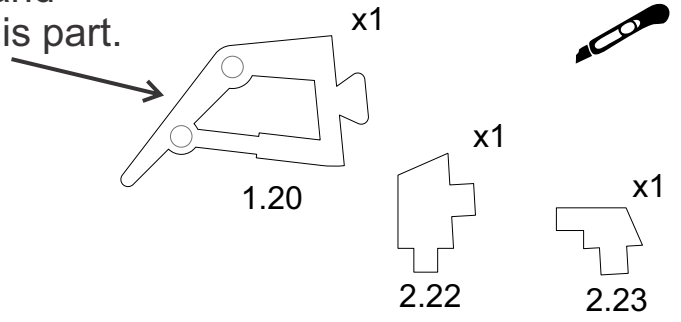

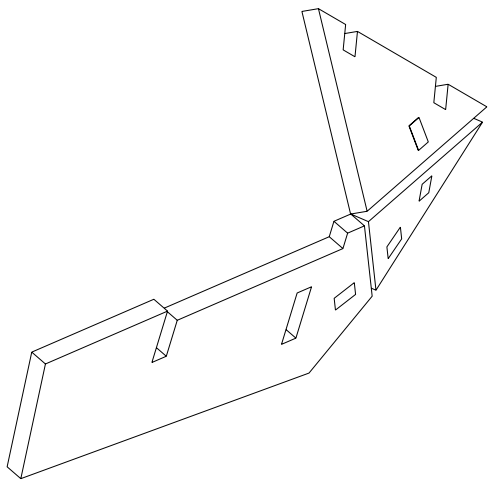
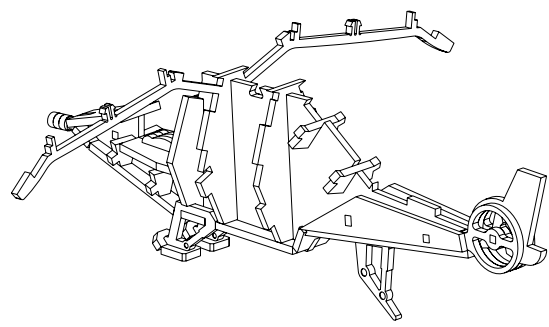
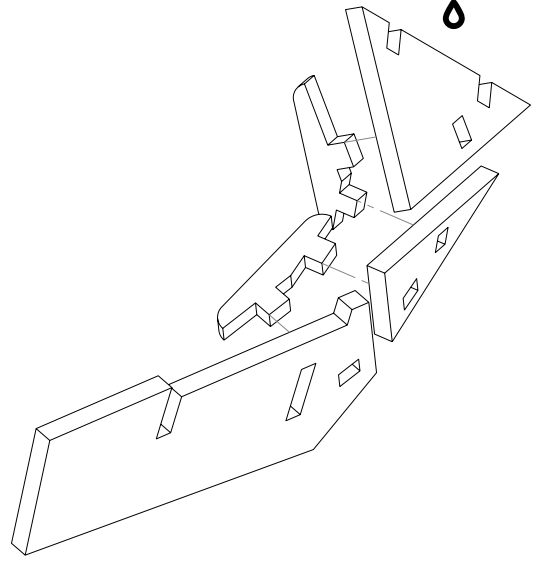
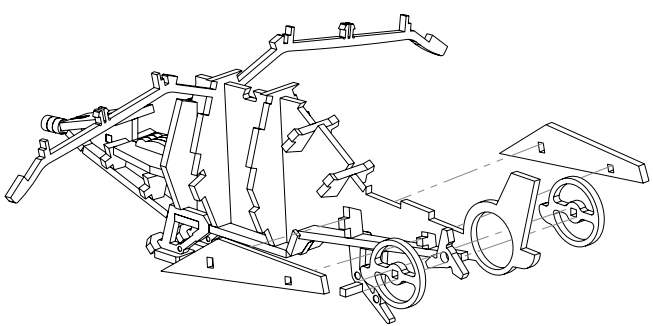
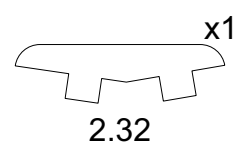
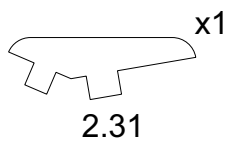
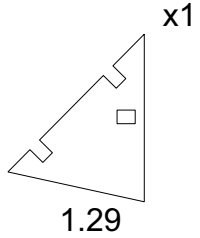
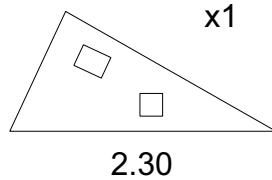
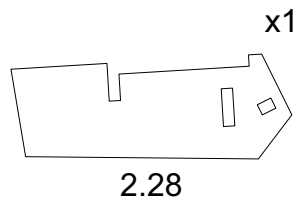
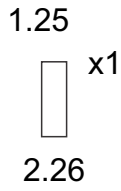
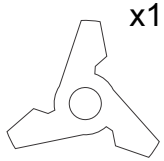
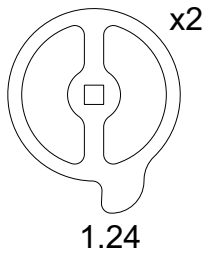

Mirror the second one. **x2**

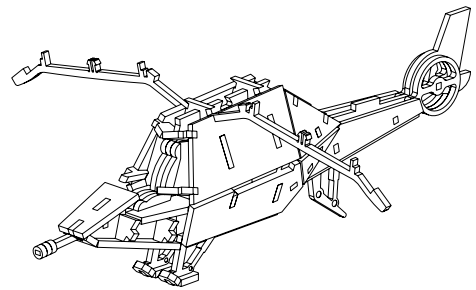
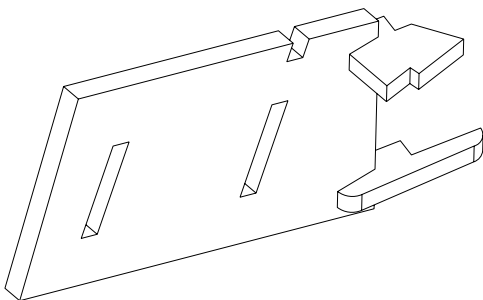
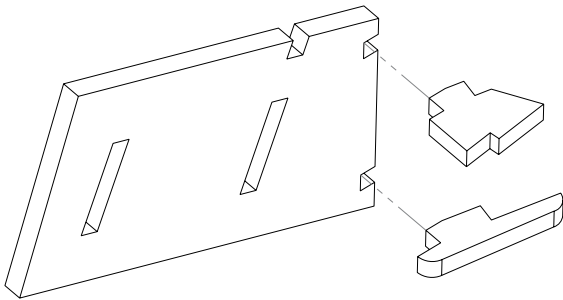
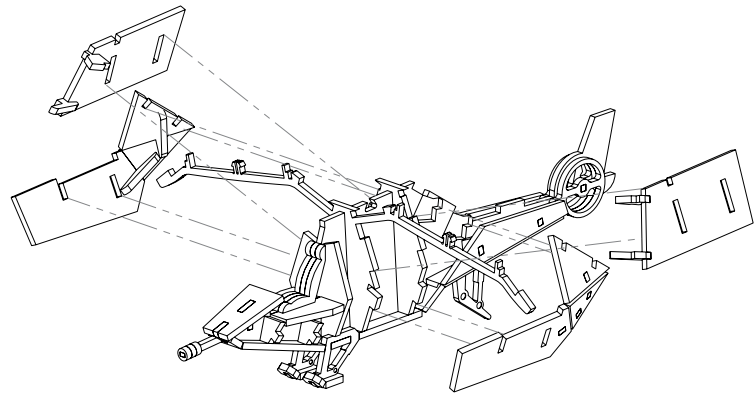
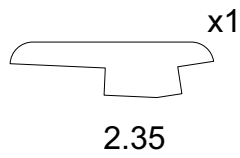
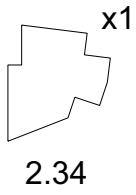
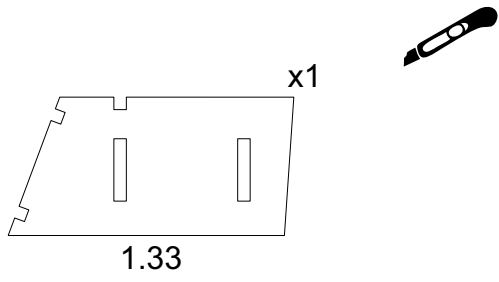

Mirror the second one. **x2**

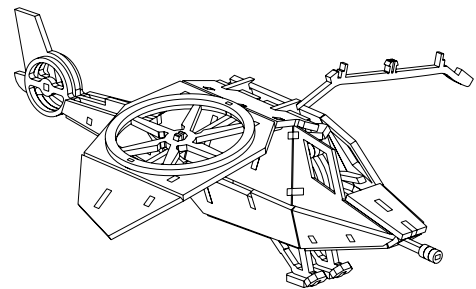
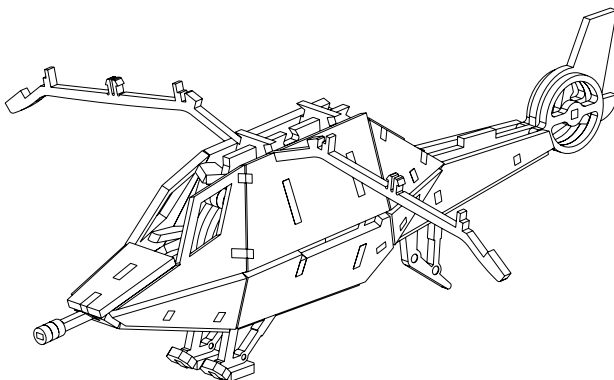
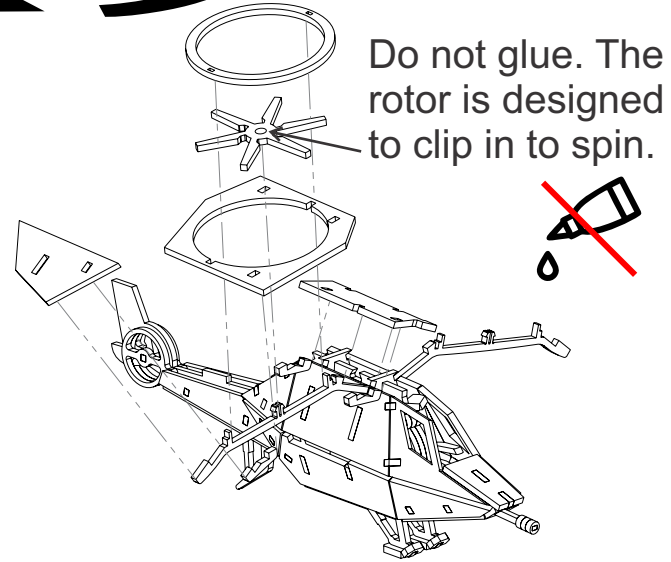
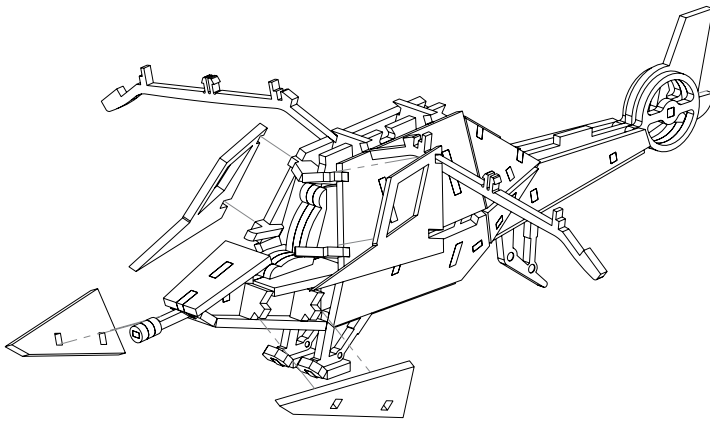
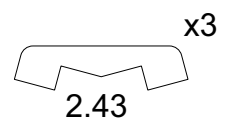
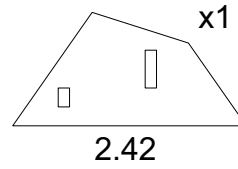
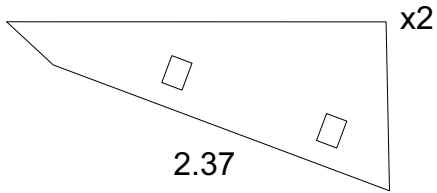
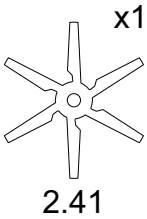
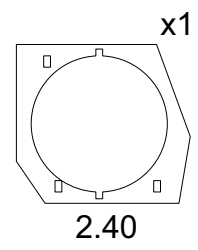
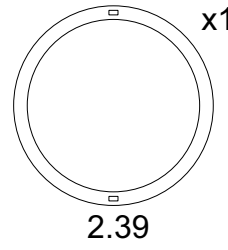
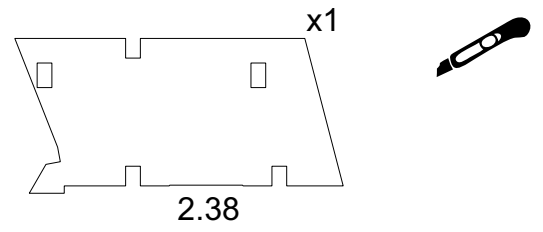
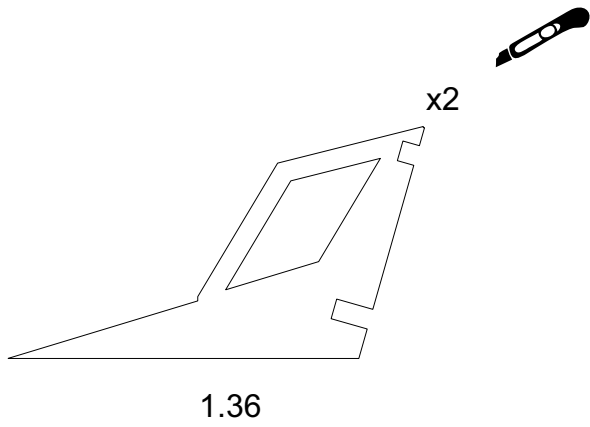

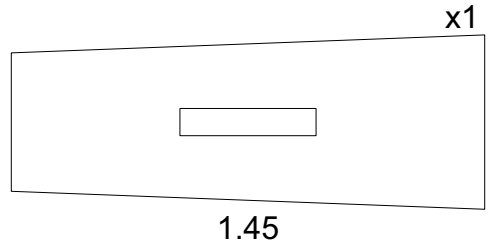
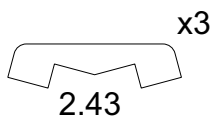
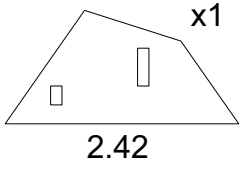
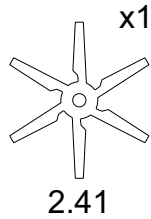
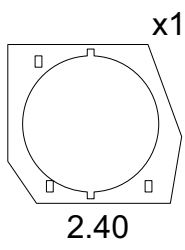
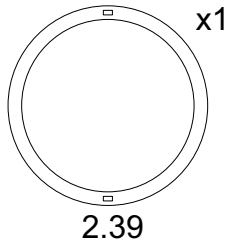
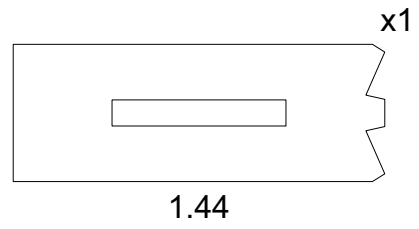
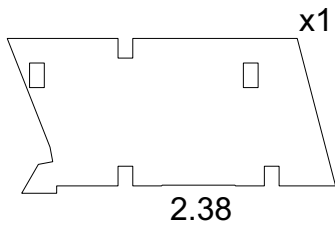

Optional, if you want to hang the BGS-v3



14

Do not glue. The rotor is designed to clip in to spin.

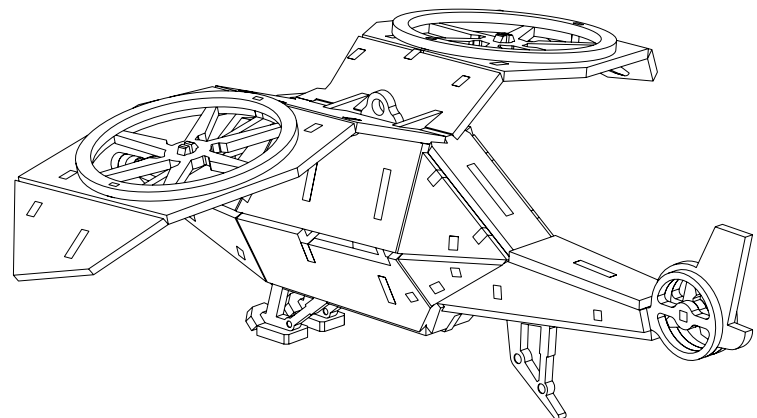
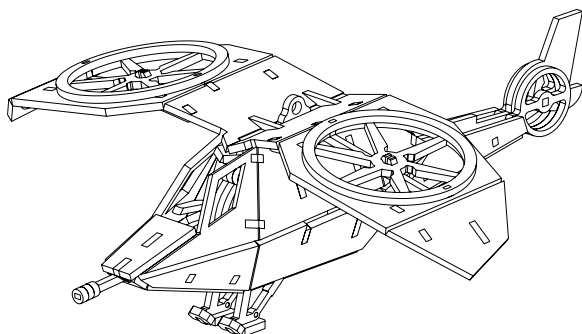
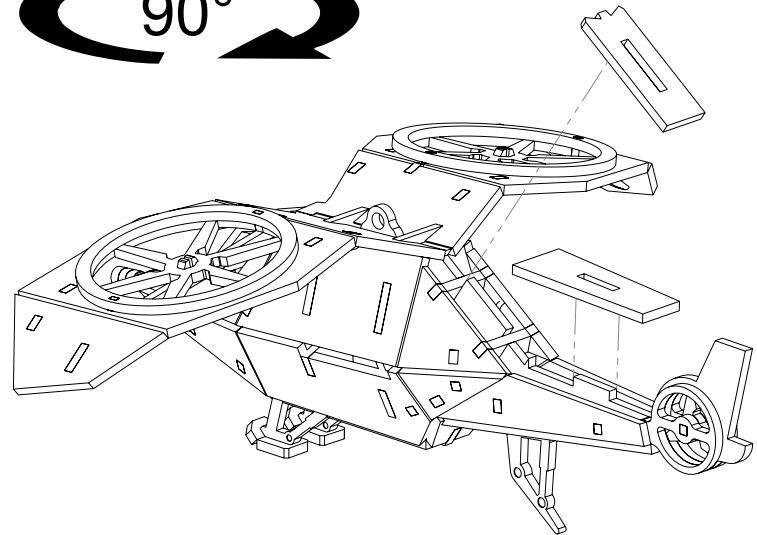
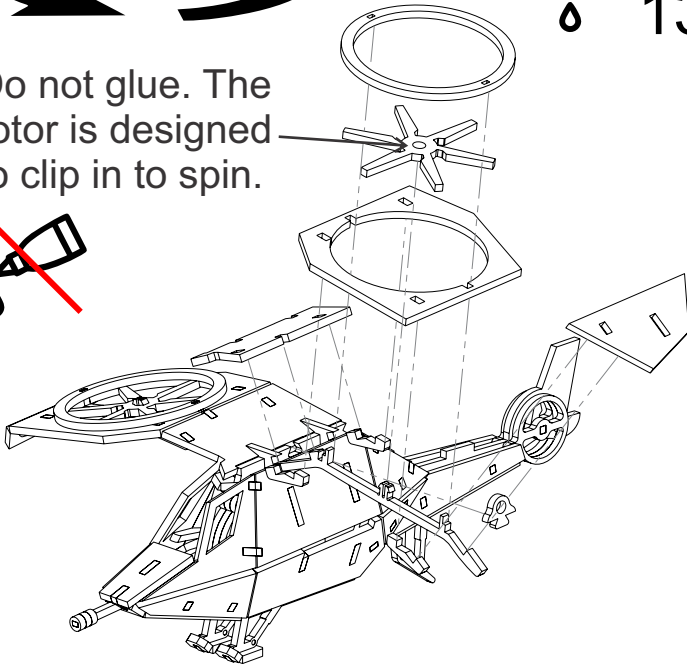



x2

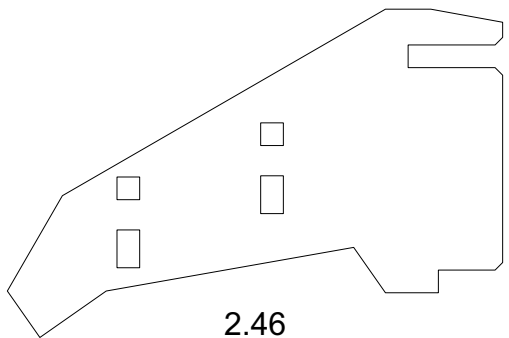

2.46

x1

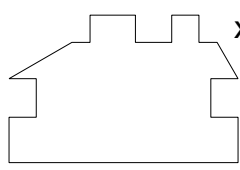

2.48

x2

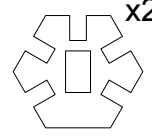

2.49



x5

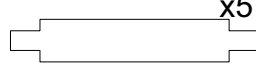

2.50

x1

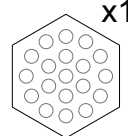

2.51



15



16

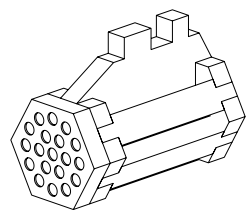
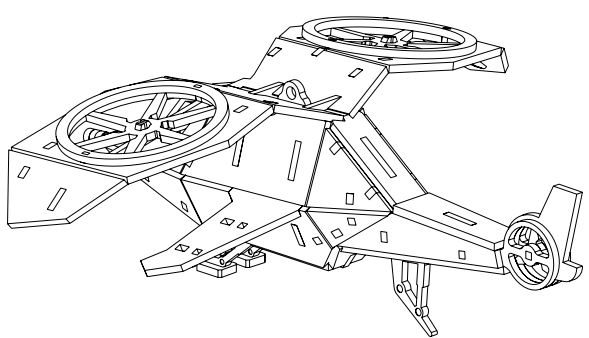
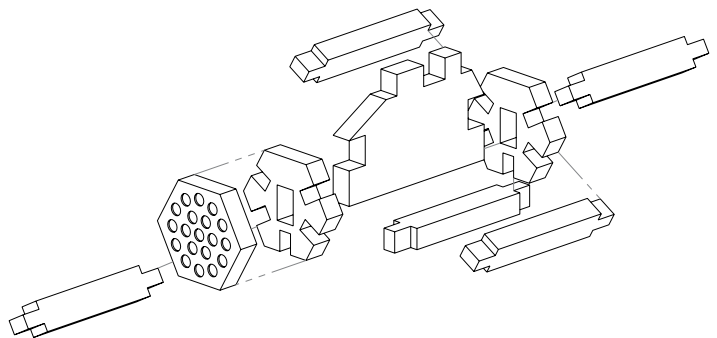
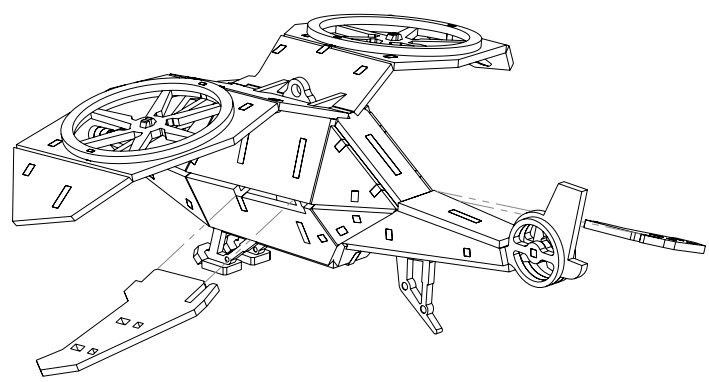
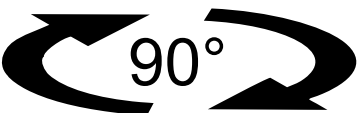

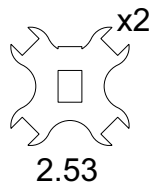
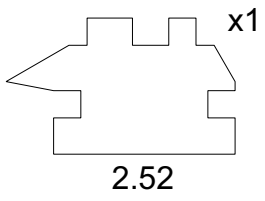

The weapons are reversible.
You can decide where you want
which weapons.

